

TOWN OF MARSHFIELD, MASSACHUSETTS

SURF AVENUE

SEAWALL REPAIR PROJECT - PHASE I

JULY 2010

CONTRACT NO. 2011-5

BOARD OF PUBLIC WORKS

ROBERT SHAUNESSY, CHAIRMAN
STEPHEN HOCKING
MICHAEL VALENTI

SUPERINTENDENT OF PUBLIC WORKS

DAVID E. CARRIERE

TOWN ENGINEER

ROD PROCACCINO

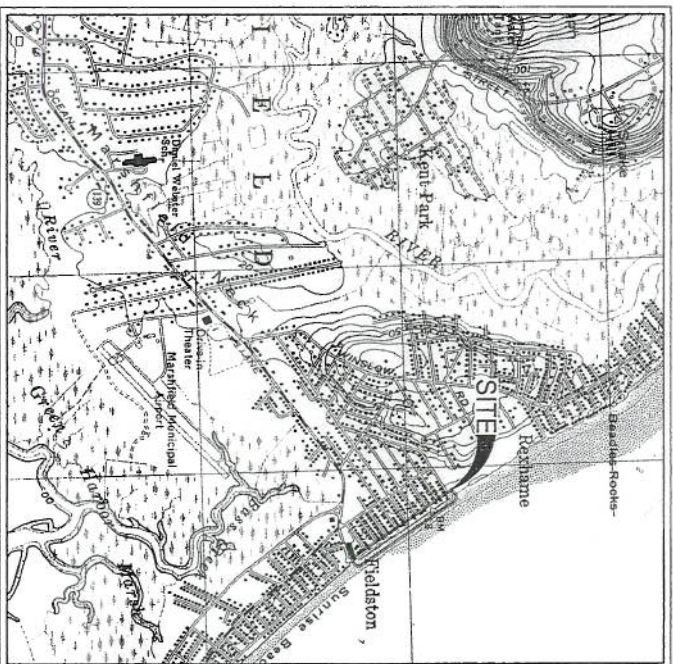

SHEET	ID
SHEET C	CC
SHEET 1	SI ST
SHEET 2	SE
SHEET 3	SE

FOR RE
OFFICIAL BID D
PLANS PRC

VINE ASSOCIATES

A DIVISION OF GZA GEOENVIRONMENTAL, INC.
HINGHAM, MASSACHUSETTS

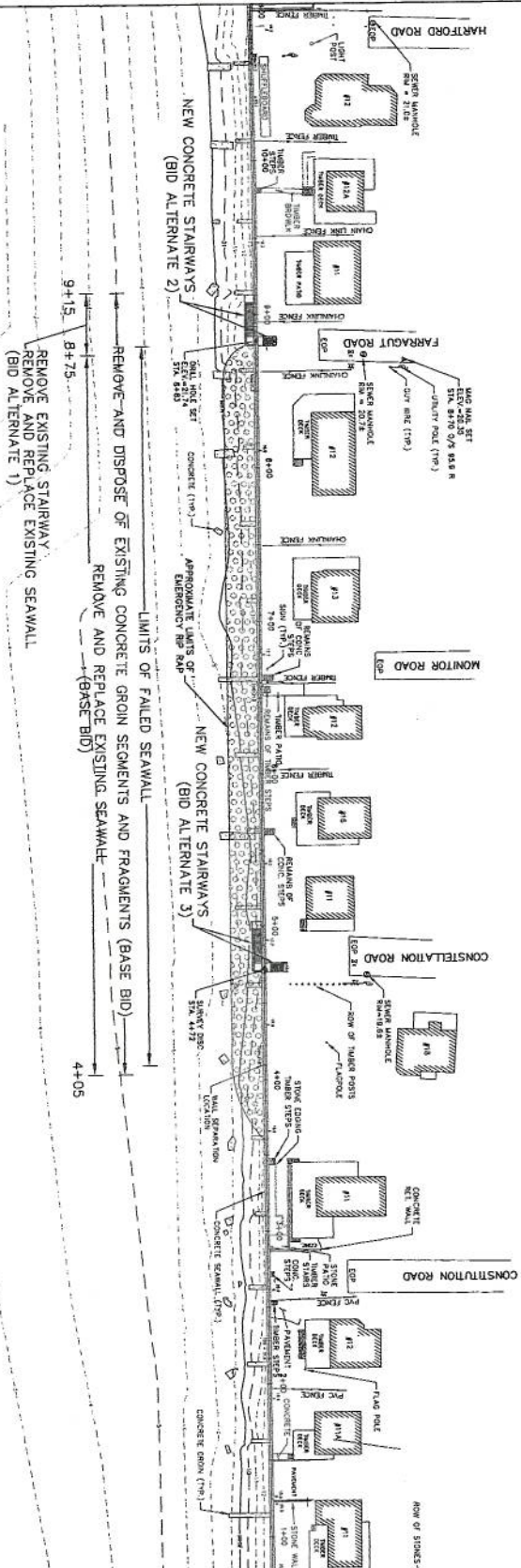

CONSTRUCTION NOTES

1. FILLING AND EXCAVATIONS SHALL BE PERFORMED IN A SAFE MANNER IN ACCORDANCE WITH ALL APPLICABLE FEDERAL AND STATE REGULATIONS AND SO AS TO PROTECT THE PUBLIC.
2. CONTRACTOR SHALL SAFEGUARD AND PROTECT ALL WORK AREAS. ALL WORK MUST BE PERFORMED IN THE DRY, UNLESS APPROVED BY THE ENGINEER.
3. EXCAVATION MATERIAL FROM THE INSTALLATION OF STONE AND FILTER FABRIC SHALL BE STOCKPILED ON SITE FOR REUSE IN THE SHORING OF THIS SITE. ALL EXCESS SOIL SHALL BE REMOVED FROM THE SITE AND DISPOSED OF PROPERLY.
4. ALL SAND EXCAVATED DURING CONSTRUCTION SHALL REMAIN ON THE BEACH IN LOCATIONS AS DIRECTED BY THE ENGINEER. AFTER CONSTRUCTION, ALL SANDS SHOULD BE SPACED TO MATCH THE PROFILE OF THE BEACH.
5. LOCATE TEMPORARY CONSTRUCTION FENCES AND BARBERS, AS DIRECTED BY THE ENGINEER.
6. ALL DEMOLITION MATERIAL SHALL BE REMOVED FROM THE SITE AND DISPOSED OF PROPERLY.
7. CONTRACTOR SHALL RESTORE SITE, INCLUDING TIMBER DECKS, STONE CURBS, BENCHES, SEATWALLS, LANDINGS, PLANTINGS, AND ADJACENT FACILITIES TO ORIGINAL PRE-CONSTRUCTION CONDITIONS, AS APPROVED BY THE ENGINEER.
8. CONCRETE:
 - a. DESIGN STRENGTH: 5,000 PSI COMPRESSIVE STRENGTH AT 28 DAYS
 - b. USE 1/2" MAX. FOR SEAWALL CONSTRUCTION. 42M, GRADE 60, F_y = 60 KSI
 - c. REINFORCEMENT SPACING SHALL BE 18" ON CENTER.
9. CONSTRUCTION JOINTS SHALL BE SPACED NO LESS THAN 20 FEET APART.
10. CONTROL JOINTS SHALL BE SPACED NO MORE THAN 5' APART.
11. CONSTRUCTION JOINTS IN SEAWALL & FOOTING SHALL BE OFFSET A MINIMUM OF 2 FEET.
12. EXISTING CONCRETE TO BE REMOVED FROM BEACH IMMEDIATELY UPON DEMOLITION. STOCKPILING OF CONCRETE ON THE BEACH FOR MORE THAN 24 HOURS IS PROHIBITED.
13. EXISTING CONCRETE SHALL NOT BE BROKEN INTO SECTIONS SMALLER THAN 2' IN LENGTH.

GENERAL NOTES:

1. EXISTING TOPOGRAPHIC AND UTILITY INFORMATION BASED ON FIELD SURVEY BY VNE ASSOCIATES, INC. ON FEBRUARY 9 AND 18, 2010. BEACH ELEVATIONS MAY VARY DUE TO SEASONAL AND WEATHER CONDITIONS.
2. VERTICAL DATUM: M.W. = 0.0, M.W. = 9.0, H.T. = 11.5. SITE BENCHMARK IS THE DRILL HOLE SET IN THE TOP OF THE SEAWALL AT STATION 0+70. ELEVATION = 2191 M.W.
3. UTILITY INFORMATION SHOWN IS BASED ON BOTH FIELD SURVEY AND THE LATEST PLANS OF RECORD. THE ENGINEER SHALL BE NOTIFIED OF ANY DISCREPANCIES WHICH WILL AFFECT SITE DESIGN. NO CHANGES IN THE FIELD WITHOUT PRIOR NOTIFICATION OF THE DESIGN ENGINEER.
4. AT LEAST 72 HOURS PRIOR TO CONSTRUCTION, THE CONTRACTOR SHALL NOTIFY, IN WRITING, ALL UTILITIES SERVING THE SITE AND CALL THE SAFE - 1-888-344-7233.
5. THE ENTIRE PROJECT SITE IS LOCATED WITHIN LAND SUBJECT TO COASTAL STORM FLOWAGE.
6. EXCAVATION MATERIAL SHALL BE STOCKPILED ON SITE FOR REUSE IN THE GRADING OF THE SITE.
7. ALL DEMOLITION MATERIAL SHALL BE REMOVED FROM THE SITE AND DISPOSED OF PROPERLY. NO DEMOLITION MATERIAL SHALL BE PLACED BELOW MEAN HIGH WATER (MHW). DEMOLITION MATERIAL SHALL BE REMOVED FROM THE BEACH AS IT IS GENERATED.

FOR RE
OFFICIAL BID DC
PLANS PRO

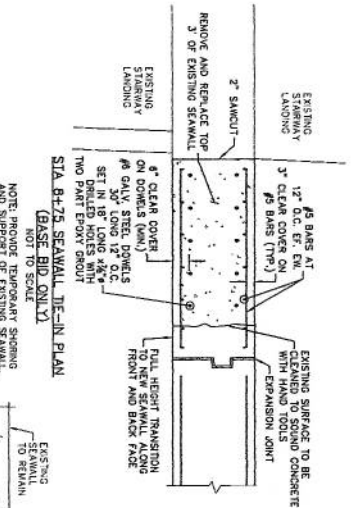
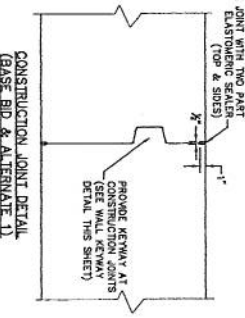
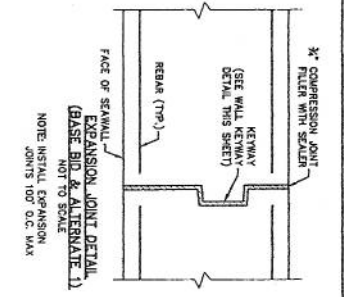
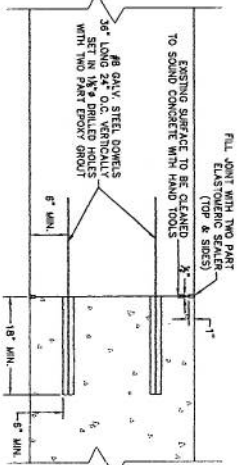
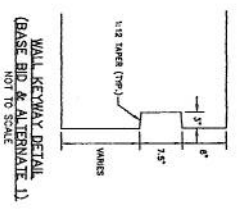
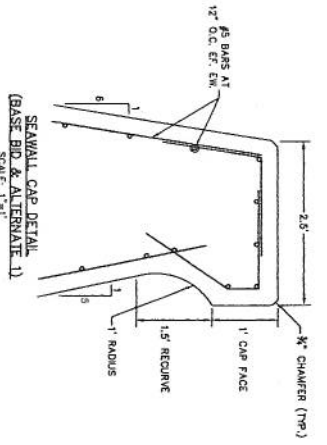
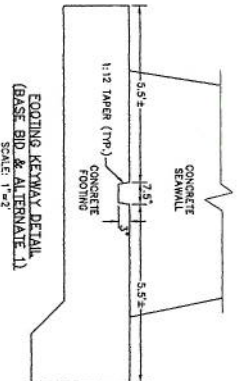
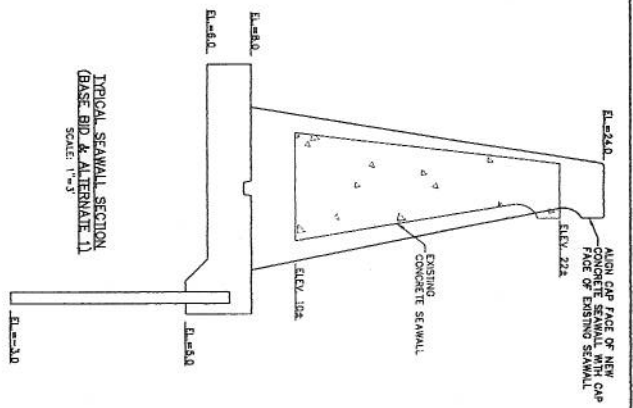

FOR REFERENCE ONLY
OFFICIAL BID DOCUMENTS INCLUDE STAMPED
PLANS PROVIDED WITH BID PACKAGE

